



INSTALLATION INSTRUCTIONS

ATV PLOW

Mount Kit: 37841

Application: YAMAHA GRIZZLY

As you read these instructions, you will see **NOTES**, **CAUTIONS** and **WARNINGS**. Each message has a specific purpose. **NOTES** are additional information to help you complete a procedure. **CAUTIONS** are safety messages that indicate a potentially hazardous situation which, if not avoided, may result in minor or moderate injury. A **CAUTION** may also be used to alert against unsafe practice or possible equipment damage. **WARNINGS** are safety messages that indicate a potentially hazardous situation, which, if not avoided could result in serious injury. **CAUTIONS** and **WARNINGS** identify the hazard, indicate how to avoid the hazard, and advise of the probable consequence of not avoiding the hazard.
PLEASE WORK SAFELY!

▲ WARNING

SEVERE INJURY OR DEATH CAN RESULT IF YOU IGNORE ANY OF THE FOLLOWING:

- Read Snow Plow Operator s Manual and all labels before operating.**
- Operate ATV at a walking speed with blade installed. Do not exceed 5 mph even with blade up.**
- Plow cautiously. Impact with an object hidden in snow could cause the ATV to stop suddenly or go out of control.**
- Do not operate ATV with blade attached on slopes greater than 10 .**
- Do not stand or ride on plow.**
- Never put feet or hands under blade.**
- Keep clear of moving parts, cable, and joints. Keep others away when operating or adjusting plow.**
- Inspect plow mechanism, fasteners, cable, and adjustments before operating.**
- Before leaving ATV unattended, stop engine, remove key, set parking brake, and lower plow blade to down position.**

YAMAHA

TOOLS REQUIRED:

Ratchet
Sockets: 7/16, 9/16"
14mm, 17mm
Wrench: 7/16, 9/16"
Phillips Screwdriver

PARTS LIST:

<u>PART NO.</u>	<u>QUANTITY</u>	<u>DESCRIPTION</u>
1321	8	1/4" Lockwasher
1322	6	1/4" Nut
3693	1	SPACER
6725	6	1/4" Nylock Nut
13253	2	1/4-20 x 1 1/4" Hex Bolt
22528	4	M10-1.25 x 30mm Hex Bolt
35391	2	J-Bolt
36522	1	Frame Mount, Right
36521	1	Frame Mount, Left
36520	2	Frame Mount, Inner
36042	1	Bumper Bracket
36041	2	Plate, Bumper Bracket
36351	1	Operator Manual

1. Snatch Block Relocation:

The Snatch Block can be secured to either side of the block support as required to provide the best cable alignment. **When using a manual lift**, it is recommended that the spacer shown in Figure 1 is installed as shown. This spacer will prevent the manual lift cable from contacting the inside of the front bumper. The spacer will not be needed when using a winch to lift the plow.

FIGURE 1: INSTALL SNATCH BLOCK SPACER

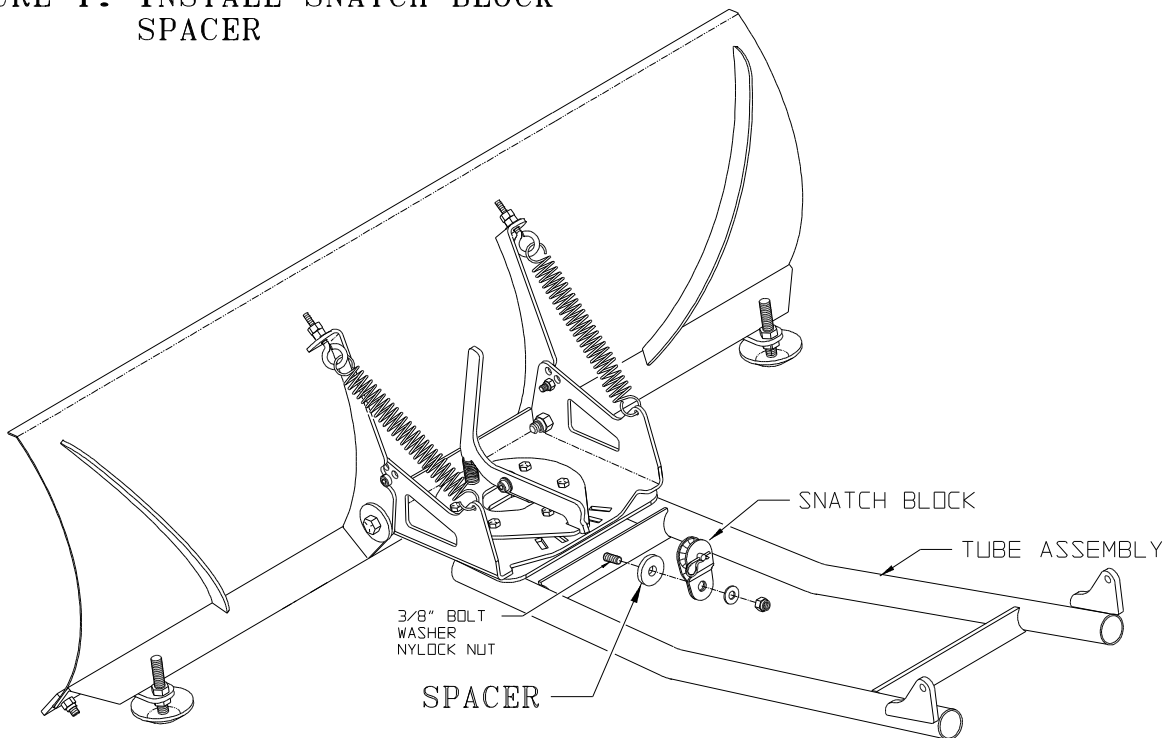

Use the fasteners shown in Figure 1 to secure the Snatch Block to Tube Assembly.

Torque 3/8" Bolt: 30ft. lb. (41 N m)

2. Frame Mount Installation:

Assemble the frame brackets as shown in Figure 2. The small zinc plated part of the frame bracket must be assembled as shown to work properly.

The 1/4" hole near the bend on the right frame mount may need to be drilled with a 1/4" drill bit to remove excess material from the forming process. Drill pin hole with 3/8" bit to remove excess material if the pin will not insert.

Right and left frame brackets are different and can only be installed on the correct side.
Remove the bolts that secure the front of the floor board to the frame. Longer fasteners have been provided in this kit to replace the factory bolts.

Secure the frame brackets to the frame with fasteners supplied

Torque fasteners to following specifications:

Torque 10mm Bolts: 35ft. lb. (48 N m)

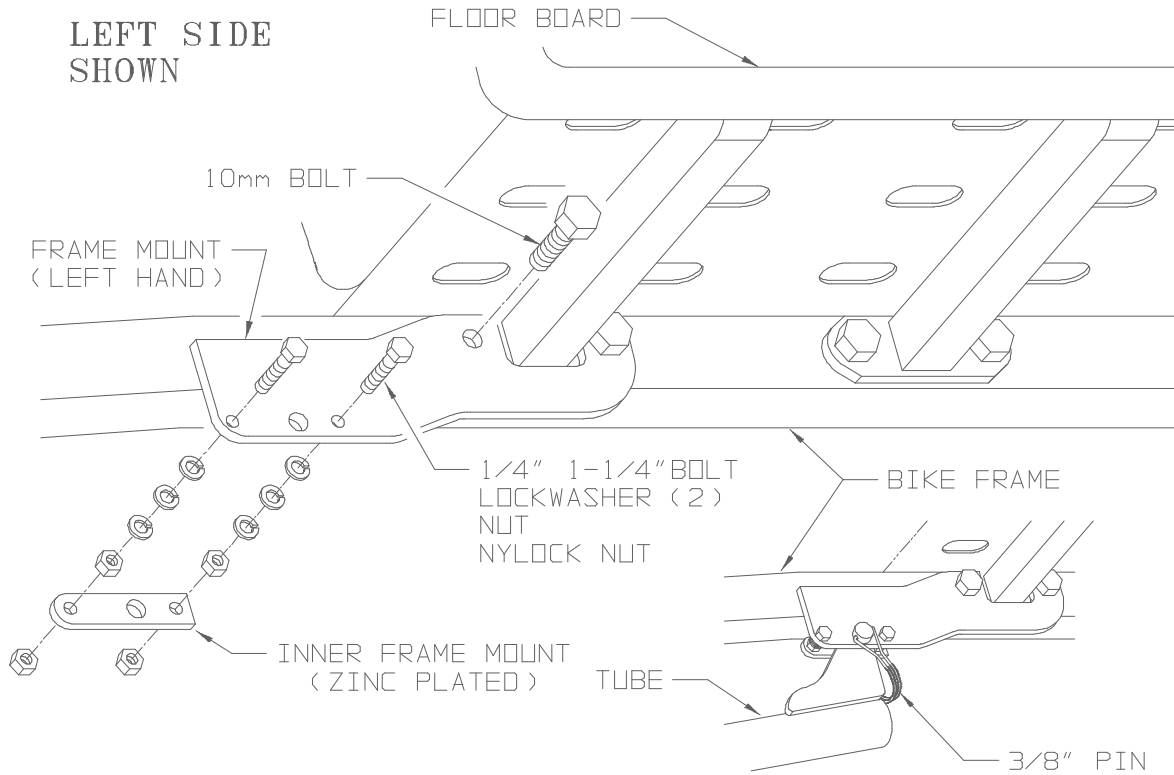

FIGURE 2: FRAME MOUNT INSTALLATION

If using the new Manual Lift PN 65510, or Electric Actuator PN 67650, disregard the instructions following this page.

Refer to the Manual Lift or Electric Actuator instructions.

3. Bumper Bracket Installation:

Fasten the bumper bracket to the inside of the front bumper with the backing plates and fasteners shown (Figure 3). This bracket can be fastened to the bumper in more than one place. To ease installation, fasten the Bumper Bracket and inside Backing Plate together with 1/4" bolts and hex nuts. These hex nuts will also prevent the bumper from being crushed when the bumper bracket bolts are tightened.

If a manual lift is used, fasten the bumper bracket so the cable from the plow is as vertical as possible. If a winch is used, fasten the bumper bracket to the right side of the bumper center section.

(Right and left sides are with respect to the rider sitting on the seat.)

The J-Bolts will not be needed when using a manual lift to operate the plow.

CAUTION: J-Bolts must be used when operating the plow with a winch. Damage to the plow, ATV and winch may occur if a J-Bolt is not used.

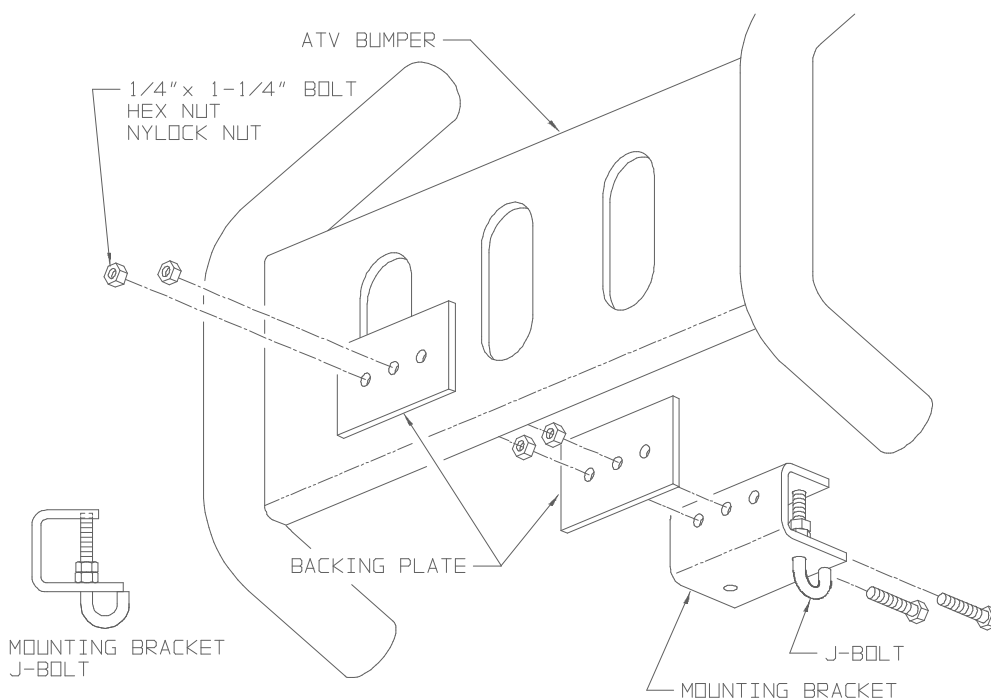

FIGURE 3: BUMPER BRACKET INSTALLATION

Note: There are three holes in the Bumper Bracket and Backing Plate. Use the center and right hole to fasten the bracket to the bumper (Figure 3).

Torque 1/4" Bolts: 8ft. lb. (11 N m)

4. Plow Installation:

Slide the plow into position with the tubes under the ATV and the snatch block approximately lined up with the inside of front bumper.

Lift the end of the tube assembly into position so the holes in the Tube Wings line up with the 3/8" holes in the frame brackets (Figure 2). A Phillips head screwdriver may be used to align the holes.

Insert both 3/8" pins and hook the retaining clips on the ends of the pins to secure the plow to the ATV.

IF A MANUAL LIFT IS USED, GO TO THE NEXT SECTION.

CAUTION: When using a winch with this plow, read your winch operator manual before proceeding with this installation. A roller fairlead must be used for lifting and lowering plow. Cable damage will occur if a roller fairlead is not used.

Remove the pulley from the snatch block by removing the retaining clip and pin.

Unspool approximately three feet (3 ft) of cable from the winch. Lay the cable in the snatch block and reinstall the pulley.

J-Bolts will be used to fasten the end of the cable to the bumper bracket. Hook the J-Bolt onto the looped end of the cable and insert the bolt through one of the holes in the bumper bracket. The cable hook should be hanging loose on the cable loop. Make sure the hook will not interfere with the cable coming out of the fairlead.

The J-Bolt must pass through both the Top and Bottom of the bumper bracket to hold the cable.

Insert the bolt through the bottom of the bracket and install two (2) 1/4" nuts on the bolt. Tighten the nuts down until the J-Bolt passes through the top of the bracket. Tighten the two nuts together to prevent them from backing off.

5. Manual Lift Mechanism Installation: (OPTIONAL)

ATVs using the manual lift mechanism (MLM) will install it as shown (Figure 4).

Using the fasteners shown, secure the MLM so the cable drops down inside the front bumper and the 1" U-Bolt is close to the formed cross bar of rack.

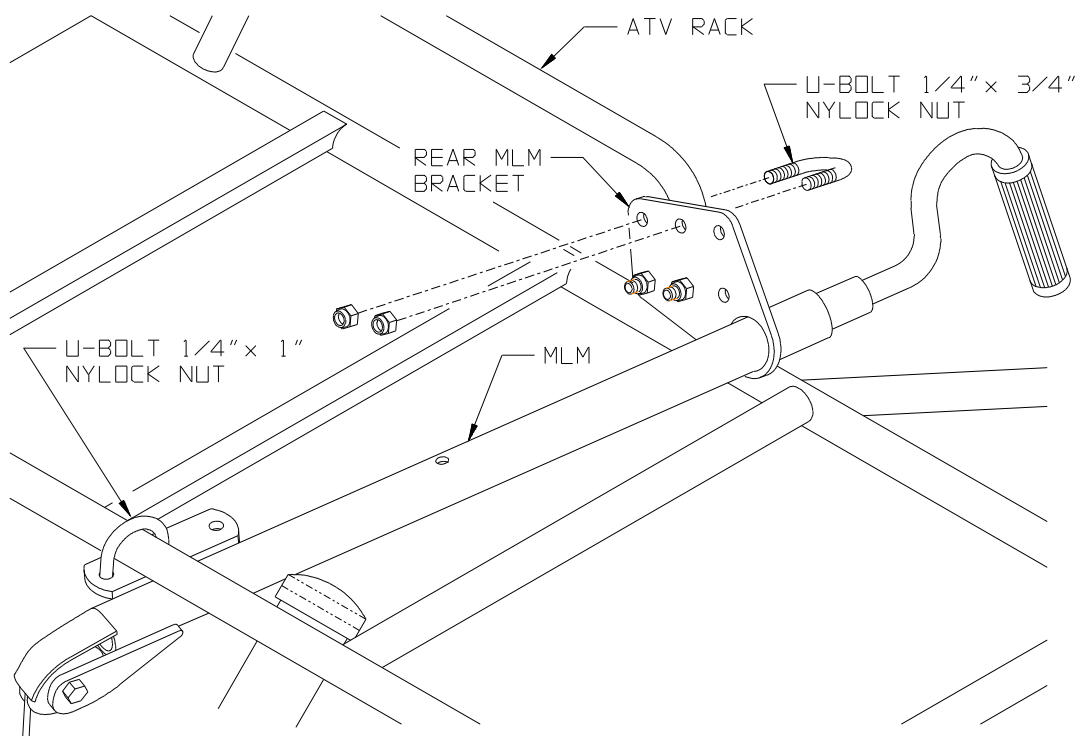

FIGURE 4: MANUAL LIFT MECHANISM INSTALLATION

The rear mounting bracket for the MLM is designed to provide some position adjustment. Use the four 1/4" holes shown to secure the rear bracket to the rack (Figure 4).

The end of the MLM tube should not be resting on the horizontal tube of the rack.

Torque 1/4" Nuts: 8ft. lb. (11 N m)

Route the cable down through the snatch block and then back up to the bumper bracket. Use two (2) 1/4" nuts to fasten the end of the cable to the bumper bracket. The first 1/4" nut should be used to tighten the cable and the second is a "Jam Nut".

Extra 1/4" flat washers have been supplied to provide more cable adjustment. The cable should be adjusted so that it is tight when the blade is on the ground. Cable tension may be increased to prevent the blade from touching the ground when in the down position.

The installation should now be complete.

Be sure to read the operator manual prior to use of this product.