



ASSEMBLY INSTRUCTIONS

ATV SNOW PLOW

Plow Kit: PN 37574

As you read these instructions, you will see **NOTES**, **CAUTIONS** and **WARNINGS**. Each message has a specific purpose. **NOTES** are additional information to help you complete a procedure. **CAUTIONS** are safety messages that indicate a potentially hazardous situation which, if not avoided, may result in minor or moderate injury. A **CAUTION** may also be used to alert against unsafe practice or possible equipment damage. **WARNINGS** are safety messages that indicate a potentially hazardous situation, which, if not avoided could result in serious injury. **CAUTIONS** and **WARNINGS** identify the hazard, indicate how to avoid the hazard, and advise of the probable consequence of not avoiding the hazard.
PLEASE WORK SAFELY!

▲ WARNING

SEVERE INJURY OR DEATH CAN RESULT IF YOU IGNORE ANY OF THE FOLLOWING:

- Read Snow Plow Operator s Manual and all labels before operating.**
- Operate ATV at a walking speed with blade installed. Do not exceed 5 mph even with blade up.**
- Plow cautiously. Impact with an object hidden in snow could cause the ATV to stop suddenly or go out of control.**
- Do not operate ATV with blade attached on slopes greater than 10 .**
- Do not stand or ride on plow.**
- Never put feet or hands under blade.**
- Keep clear of moving parts, cable, and joints. Keep others away when operating or adjusting plow.**
- Inspect plow mechanism, fasteners, cable, and adjustments before operating.**
- Before leaving ATV unattended, stop engine, remove key, set parking brake, and lower plow blade to down position.**

YAMAHA

FIGURE 1: PLOW ASSEMBLY

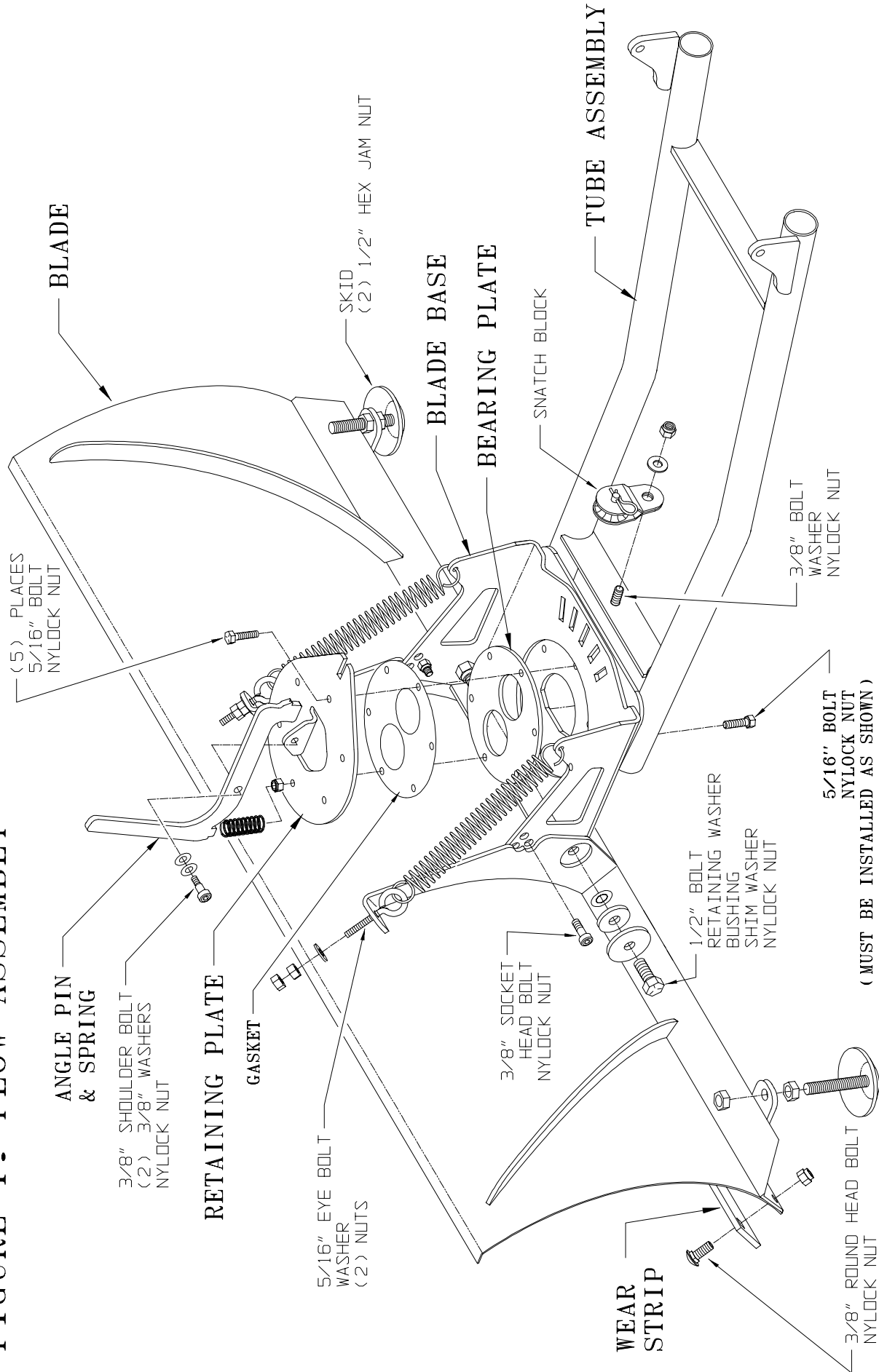

TOOLS REQUIRED:

Ratchet
Sockets: 1/2, 9/16, 3/4"
3/16", 5/16" Allen Socket or Wrench
Wrench: 1/2, 9/16, 3/4"

PARTS LIST

<u>PART NO.</u>	<u>QUANTITY</u>	<u>DESCRIPTION</u>
1324	2	5/16" Flat Washer
2002	7	5/16" Nylock Nut
2079	4	5/16" Nut
4504	2	3/8" Socket Head Bolt
6779	10	3/8" Nylock Nut
6818	2	1/2-13 x 1 1/2" Hex Bolt
6960	1	3/8-16x 1 1/4" Hex Bolt
13470	6	5/16"-18 x 1 1/4" Hex Bolt
22062	7	3/8-16 x 1" Round Head Bolt
27961	1	Clip
29060	2	1/2" Nylock Nut
31792	1	3/8" Shoulder Bolt, (5/16" Thread)
35124	1	Snatch Block, Pulley
35136	2	3/8" Pin w/Clip
35329	2	5/16" Eye-Bolt
37100	2	Large Spring, Tension
60735	1	Gasket, Plow Base
37453	2	1/2" Shim Washer
37837	1	Spring, Compression, Pin
37454	2	Retaining Washer, Rib
37455	2	Bearing, Rib
37918	1	Angle Adjustment Pin
37456	1	Retaining Plate, Base
37095	1	Bearing Plate, Base
37573	1	Plow Blade, 48"
37572	1	Blade Base
61391	1	Tube Assembly
37566	1	Wear Strip
38330	1	Skid Kit

1. Complete Assembly of Base:

Blade Base:

Angle Pin: Make sure that the slots in the Retaining Plate, Blade Base, and platform of the Tube Assembly are Aligned. Place the small compression spring over the 5/16" Nylock nut closest to the back of the blade.

Now install the pin so the nose of the pin, section of pin farthest from handle, falls into the Retaining Plate slot. The spring should be seated in the heel of the pin and compressed to allow the Angle Pin to fit correctly into position.

With the two 3/8" washers on the shoulder bolt, align the hole in the Angle Pin with the hole in the Retaining Plate and insert the bolt. Secure the bolt with a 5/16" Nylock nut.

Torque 5/16" Bolts: 17ft. lb. (23 N m)

If the Angle Pin does not move freely, remove one of the 3/8" washers.

Blade Stops: Two 3/8" socket head bolts will be used as blade stops. Fasten these bolts to the base with the head of the bolt on the outside of the base.

NOTE: There are three 3/8" hole locations on both sides of the base. Each location will provide a different "Attack Angle" for each users specific needs or preference. We recommend the middle (Lower Hole) position for most applications.

The socket head bolts MUST be installed in the same location on both sides of the base. Failure to assemble correctly will result in damage to the plow.

Torque 3/8" Bolt: 30ft. lb. (41 N m)

Plow Tubes:

Remove the snatch block and a retaining clip from the hardware bag (Fig. 1). The clip will replace the smaller one already on the snatch block. The larger clip will make plow removal easier.

Use the fasteners shown in Figure 1 to secure the snatch block to tube assembly. The snatch block can be secured to either side of the block support as required to provide the best cable alignment.

Torque 3/8" Bolt: 30ft. lb. (41 N m)

2. Secure Blade to Blade Base:

Blade:

Fasten the wear strip to the **Front** of the blade with seven 3/8" carriage bolts. The wide section of material should be down.

Torque 3/8" Bolt: 30ft. lb. (41 N m)

Blade Skids: (Optional)

Skid mounting tabs have been welded in place on the back side of the plow blade. Install one 1/2" fine thread jam nut on each skid so that it is near the bottom of the threaded stud.

Now insert a skid through both Skid Mount tabs and adjust the nuts so the blade will sit evenly on the ground. Secure the skids using the 1/2" fine thread jam nuts provided.

Torque 1/2" Bolt: 35ft. lb. (47 N m)

Align the large 1 1/2" holes in the blade ribs with the 1/2" holes in the sides of the Blade Base. Install a Retaining washer, Bushing, and 1/2" Shim washer on both 1/2" bolts (Fig. 1).

Now insert the 1/2" bolts through the blade ribs and into the Blade Base. Secure the 1/2" bolts with 1/2" Nylock Nuts.

Torque 1/2" Bolt: 75ft. lb. (100 N m)

Hook both large springs to the blade base (Fig. 1). Hook the free end of each spring onto an eye-bolt.

Do Not cut or bend the ends of the springs to ease installation.

Now secure the threaded end of the eye-bolts to the blade ribs (Fig. 1). The springs may need to be stretched to fasten the eye-bolt to the rib. This may require a second person to assist.

Use the first 5/16" nut to stretch the spring and the second as a "Jam Nut" to prevent the nut from backing off.

Note: Operating the plow with the springs at maximum tension can cause the springs to be over stretched. Over stretched springs will reduce plow pushing capabilities.

The plow assembly is now complete.

Be sure to read the operator manual prior to use of this product.