



# INSTALLATION INSTRUCTIONS

## Replacement Brake Kit

Important: This service kits comes with either two 1/4" lockwashers, for gray motors, or four 1/4" star-washers, for black motors.

Part No. 22142

### Preparation:

The wire rope must be secured to the drum prior to disassembly.  
Disconnect the winch from its power source and remove from mounting location.

### Disassembly:

Place the clutch into the "Freespool" position before disassembly.

Remove the two 1/4-20 capscrews holding the motor end housing to the drum.

Remove the two remaining 1/4-20 capscrews holding the wire rope protectors to the end housing.

Disassemble motor end housing as shown below.

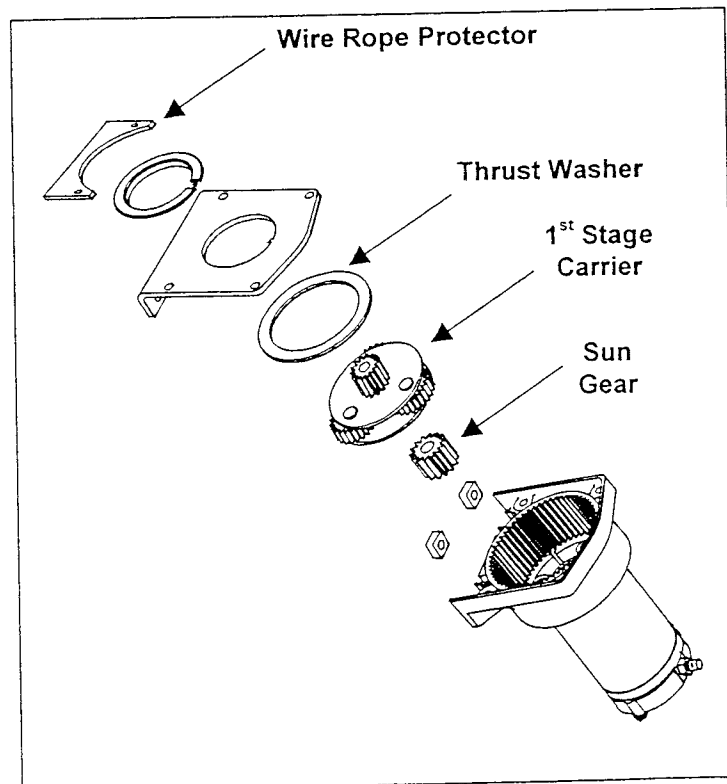

**Note:** Before removing the two motor bolts secure the motor cap to the motor housing. This can be done using a piece of duct tape.

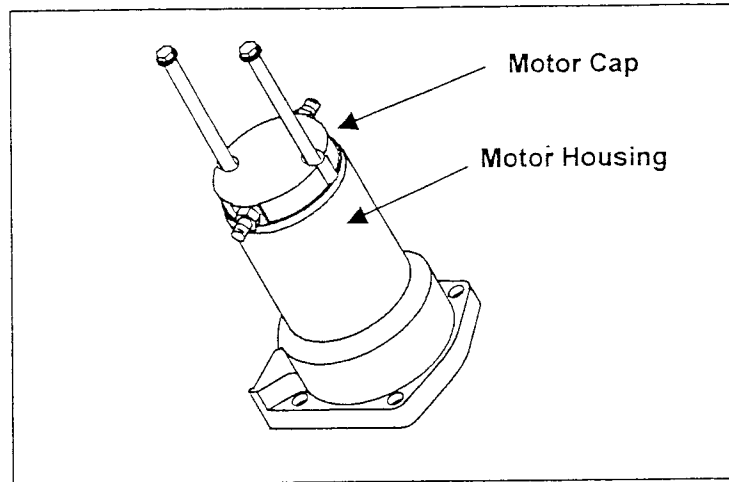

After securing the motor cap remove the two motor bolts and place the proper washers on, two black star washers on each bolt for black motors or one lock washer for gray motors.

Replace the two square nuts into the end housing and retighten the motor bolts to 3 foot-pounds.

Reassemble the motor endhousing assembly as shown below. Note the new location of the thrust washer and that the sun gear is no longer need.

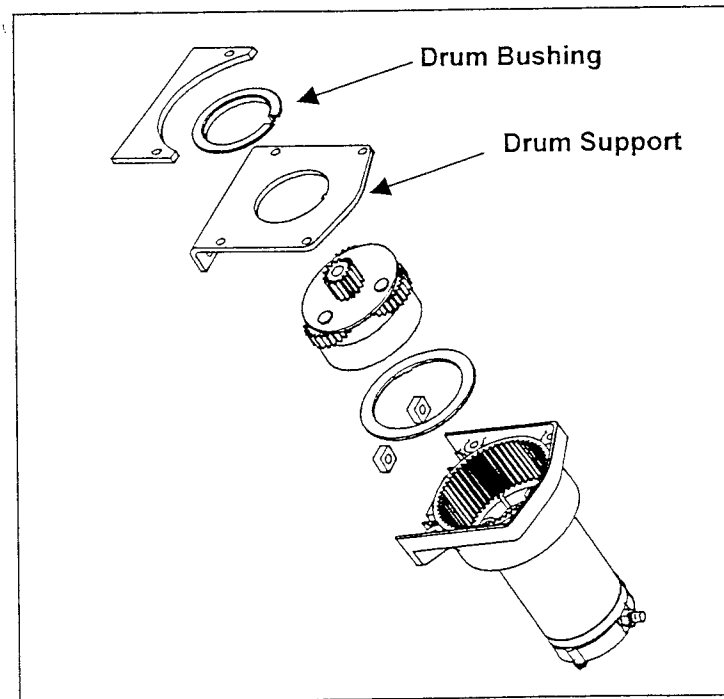

Assure that the drum bushings are aligned in the drum supports and reassemble the winch.